

INDUSTRIAL PARK LUMACO ČADCA

Projection and design works
Manufacture of conveyors
Manufacture of grippers
Manufacture of fixtures to automated production lines
Manufacture of welding guns
Production of special one-purpose machines
Production of service platforms
Production, assembly and revisions of electrical cabinets

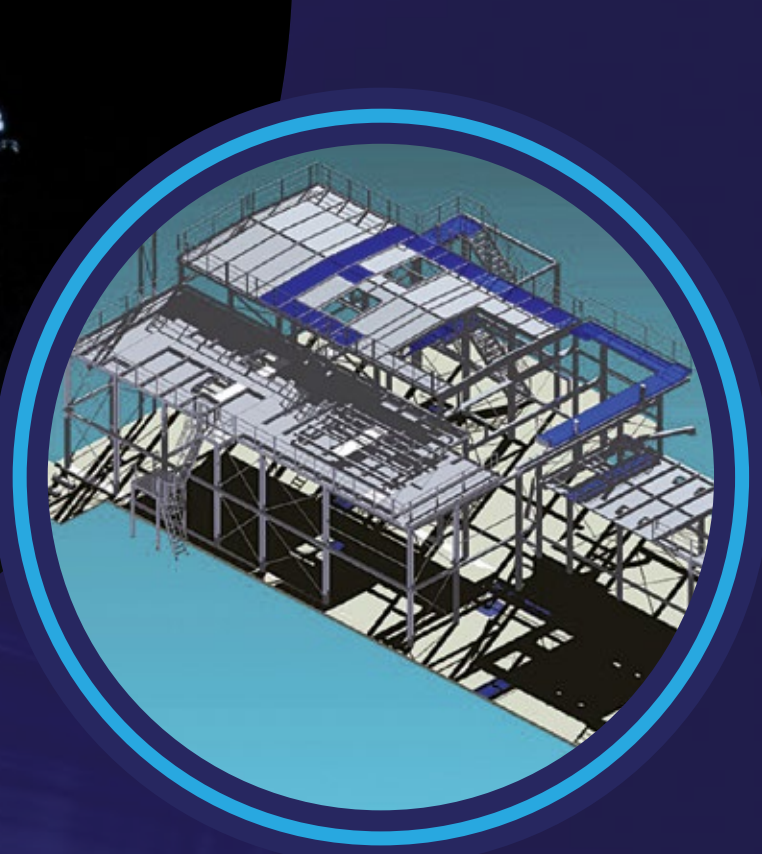

www.lumaco.eu

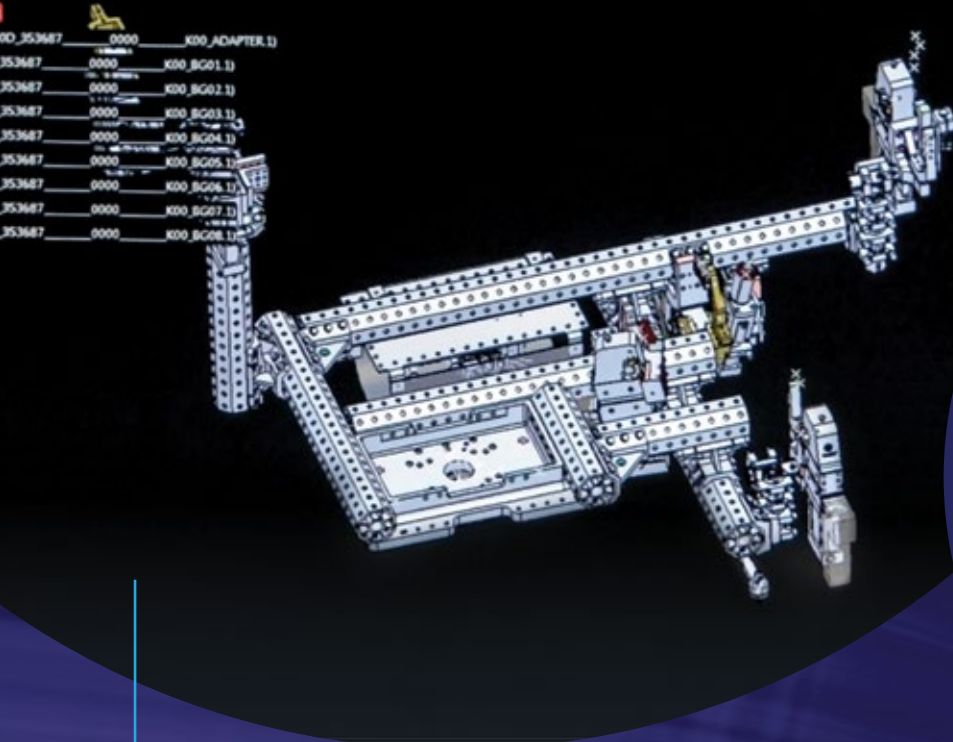

• Projection and design works

Development and design of machine parts and assemblies for automotive industry, traffic engineering and general engineering (CAD systems)

Design of 2D or 3D solutions

Processing of data into the digital form

Design activities in CATIA V5 R24 and Autodesk Inventor i10

• 3D measurement, scanning

3D Measurement and scanning using most advanced technologies



Manufacture of Grippers •

Our employees are fully qualified, skilled and continuously trained for working with the latest technology. Production and assembly workplaces are equipped with technically skilled personnel that carries out the assembly at modern workplaces (particularly in a 3D environment with the drawings shown on computers, thereby we also contribute to achieve the environmental objectives).

Manufacture of conveyors •

Mechanical conveyors:
- driven by roller, belt, chain
- modular driven
- unpowered (roller)

Conveyors using kinetic energy
(roller - storage)

Hydraulic conveyors
(conveyors on platform)

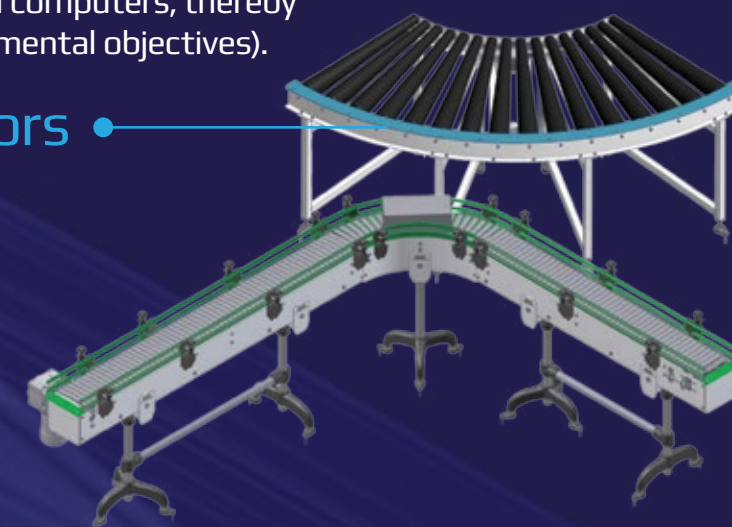



• Manufacture of fixtures for automotive industry

Welding fixtures
Assembly fixtures
Laser stations
Turn tables



• Production of service platforms

Our service platform can be used for maintenance and repair of equipment in exposed areas where it is not possible to use traditional mobile platforms, scaffoldings or cranes.

Highlights include especially the efficiency of the service time in the car-production lines, simple and very quick installation.

The extent of the service platform can be determined arbitrarily as needed (modification for different types of platforms possible). Complete assembly time approx 10 minutes.



• Manufacture of welding guns

Welding guns manufacture and assembly on the basis of the project documentation provided by the customer.

Production, assembly and revisions for electrical equipment

Our company is providing complete electrical assembly according to the customer's requirements. If needed we can modify equipment and update current documentation.

We have long term cooperation with major suppliers of electrical and technical materials so we can guarantee the best prices. We are providing repairs and revisions of electrical equipment.



• Production of special one-purpose machines

Self invented solution of automated screw device manufactured in Industrial Park of LUMACO, Čadca

We manufacture various handling fixtures for automotive industry (eg. LCA trucks, gravity tanks)

References

Development and construction of acoustic barrier for gas generator in nuclear power plant RioTinto Yarwun (Australia) 2008

Development, construction, production and assembly of conveyor system for wood waste removal for Drevo SV Snina (Slovakia) 2009

Development, construction, production and assembly of the robotic maintenance platform for KIA Žilina (Slovakia) 2015

Development, construction, production and assembly of automated production line station for engine assembly line automated screwing process. Turn key solution with electric design and programming. KIA Žilina (Slovakia) 2015

Production and assembly of grippers for industrial robots for Thyssen Krupp Heillborn in LUMACO industrial park (Slovakia) 2016

Complete assembly of electrical cabinet with testing and final measurements for Manz in LUMACO industrial park (Slovakia) 2016



Our company holds certificates **ISO 9001:2008**,
ISO 14001:2005, **SCC** Version 2011**.
Our employees have **SCC** certificates issued
by **TÜV SÜD Slovakia**



Contacts



Potočná 2742, 022 01 Čadca
Slovak Republic
email: lumaco@lumaco.eu
web: www.lumaco.eu



LUMACO SK s.r.o.
Potočná 2742
022 01 Čadca
Slovak Republic



LUMACO GERMANY GmbH
Ludwig Ganghofer-Straße 24
820 31 Grünwald
Germany



LUMACO SWISS GmbH
Sihleggstrasse 23
8832 Wollerau
Switzerland



LUMACO CZECH s.r.o.
Husinecká 930/10
130 00 Praha 3
Czech Republic



LUMACO U.S., LLC
6201 Fairview Road,
Suite 330, Charlotte,
NC 28210 | USA

our companies •